

Chain Block

OPERATORS MANUAL

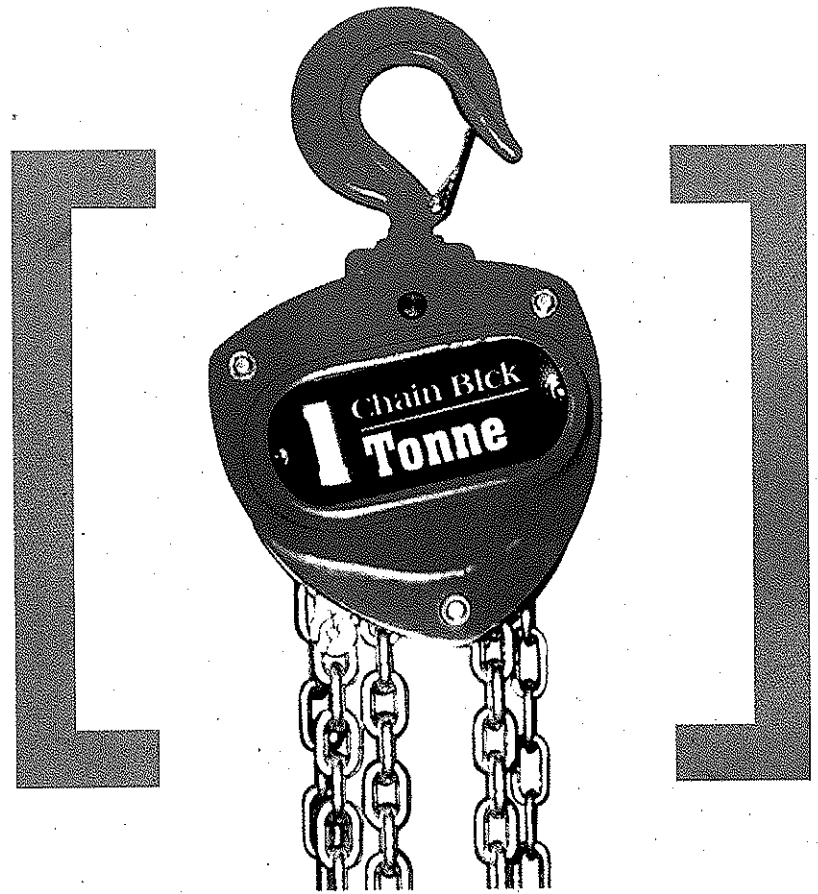

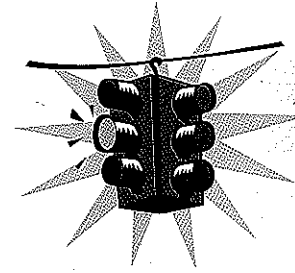

WARNING!

Ensure that you have read the operating instructions fully and understand them prior to using the chain block.

- Never shock load the chain block.
- The chain block should be visually inspected for damage or faults prior to use.
- Never exceed the rated capacity of the chain block.
- Do not use the load chain as a sling. This will damage the load chain.
- Do not use more than one chain block to lift or move a load.
- Do not use the chain block if the chain is twisted, kinked or damaged.
- Do not operate the chain block unless the load is centred between the top and bottom hooks.
- Never use the chain block if either hook is stretched, deformed, damaged or has a broken or missing safety catch.
- Only qualified personnel should operate chain blocks.
- Do not use the chain block to lift people or loads over people.

PARTS LIST

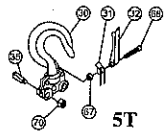

30	Top Hook Assy.	67	Lock Nut
31	Double Spring	68	Screw
32	Safety Latch	70	Lock Nut
35	Top Hook Pin		

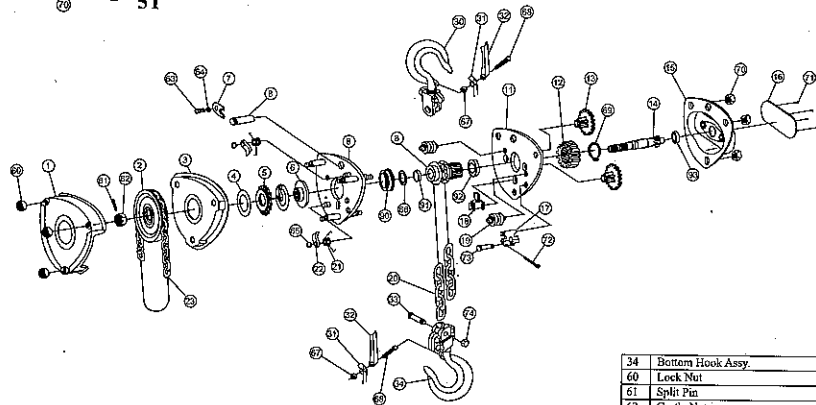

1	Hand Wheel Cover	8	Hook Connector
2	Hand Chain Wheel	9	Left Side Plate Assy.
3	Protective Cover	10	Load Chain Sprocket
4	Friction Plate	11	Right Side Plate Assy.
5	Ratchet Disc	12	Split Gear
6	Brake Seat	13	Disk Gear Assy.
7	Positioning Plate	14	Shaft

15	Gear Cover	65	Snap Ring
16	Name Plate	66	Snap Ring
17	End Anchor	67	Lock Nut
18	Stripper	68	Screw
19	Guide Roller	69	Snap Ring
20	Load Chain	70	Lock Nut
21	Fawl Spring	71	Name Plate Rivet
22	Fawl	72	Split Pin
23	Hand Chain	73	Pin Shaft
30	Top Hook Assy.	74	Lock Nut
31	Double Spring	90	Left Bearing
32	Safety Latch	91	Needle Bearing
33	Suspension Pin	92	Right Bearing
		93	Bearing

31	Double Spring	67	Lock Nut
32	Safety Latch	68	Screw
36	Idle Sheave Assy.	70	Lock Nut
37	Bottom Hook Assy.	75	Pin
38	Bottom Hook Assy.		

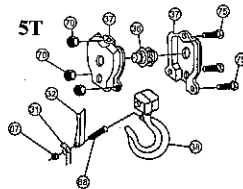

MAINTENANCE

- 1: After use clean any dirt or water off the unit and lubricate the load chain and swivel hook.
- 2: Maintenance and inspection should only be carried out by qualified personnel
- 3: After repairs or maintenance the chain block should be tested to ensure that it is operating correctly.
- 4: If the chain block is used outdoors additional care should be taken regarding maintenance.

INSPECTION

- 1: The chain block should be inspected prior to use for any damage or faults. Also listen for unusual sounds which may indicate trouble.
- 2: Brakes require more than audio-visual inspection. Check frequently by operating the chain block with and without a load, stopping at various positions to test that the load is being held correctly. If the load moves or slips the chain block should be taken out of service and repaired.



Never exceed the rated capacity of the chain block.



Do not operate the block if the chain is kinked, damaged or twisted.

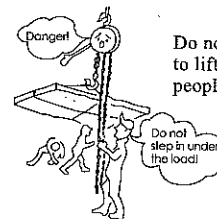

Do not use the chain block to lift people or loads over people.



If you are unable to move the hand chain, stop immediately and inspect the chain block for damage

CHAIN AND HOOKS

The hooks and load chains are made of special alloy-steels and are precisely heat-treated. Never weld or heat-treat them again.

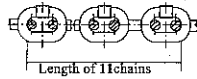

(a) Load Chain

The load chains are exceptionally long-wearing, but wear is unavoidable and certain conditions will cause wear and corrosion that will lessen the strength. Load chains worn beyond the permissible limits shown in the Table 1 must be replaced at once.

CHAIN DIMENSIONS

Capacity (Tons)	Diameter of Chain Wire	Maximum Allowable Gauge Length (11 links)
0.5	Ø 5.0mm	169.95mm
1	Ø 6.3mm	215.27mm
2	Ø 8.0mm	271.92mm
1.6 3	Ø 7.1mm	237.93mm
5 10	Ø 9.0mm	305.91mm



(b) Hooks

The hook opening will elongate with overloads and incorrect hooking. When the hook opening is elongated beyond the permissible limits shown in the Table 2, it is dangerously deformed and must be replaced immediately.

HOOK THROAT OPENING

Capacity (Tons)	Hook Throat Opening	
	New Hook O Equals	Replace When O Equals
0.5	23.6mm	25.96mm
1	28.0mm	30.80mm
1.6	31.5mm	34.65mm
2	33.5mm	36.85mm
3	37.5mm	41.25mm
5	42.5mm	46.75mm
10	60.0mm	66.00mm

ALIGNMENT OF GEARS DURING REASSEMBLY

All Capacities

Align teeth between two marks at the gear spline on horizontal centerline, one facing toward centre and one facing outward, as shown.

(Inner/Outer relation)

